



# YGE 60 Cell 40mm SERIES

## ELECTRICAL PERFORMANCE

### Electrical parameters at Standard Test Conditions (STC)

Module type	YLxxxP-29b (xxx=P <sub>max</sub> )								
	P <sub>max</sub>	W	260	255	250	245	240	235	230
Power output	P <sub>max</sub>	W	260	255	250	245	240	235	230
Power output tolerances	ΔP <sub>max</sub>	W	0 / 5						
Module efficiency	η <sub>m</sub>	%	15.9	15.6	15.3	15.0	14.7	14.4	14.1
Voltage at P <sub>max</sub>	V <sub>mpp</sub>	V	30.9	30.6	30.4	30.2	29.5	29.5	29.5
Current at P <sub>max</sub>	I <sub>mpp</sub>	A	8.41	8.32	8.24	8.11	8.14	7.97	7.80
Open-circuit voltage	V <sub>oc</sub>	V	38.9	38.7	38.4	37.8	37.5	37.0	37.0
Short-circuit current	I <sub>sc</sub>	A	8.98	8.88	8.79	8.63	8.65	8.54	8.40

STC: 1000W/m<sup>2</sup> irradiance, 25°C cell temperature, AM1.5g spectrum according to EN 60904-3.  
Average relative efficiency reduction of 5% at 200W/m<sup>2</sup> according to EN 60904-1.

### Electrical parameters at Nominal Operating Cell Temperature (NOCT)

Power output	YLxxxP-29b (xxx=P <sub>max</sub> )								
	P <sub>max</sub>	W	188.3	184.7	181.1	177.9	174.3	170.7	167.0
Voltage at P <sub>max</sub>	V <sub>mpp</sub>	V	28.1	27.9	27.6	27.2	26.6	26.6	26.6
Current at P <sub>max</sub>	I <sub>mpp</sub>	A	6.70	6.63	6.56	6.54	6.56	6.42	6.29
Open-circuit voltage	V <sub>oc</sub>	V	35.9	35.7	35.4	34.5	34.2	33.8	33.8
Short-circuit current	I <sub>sc</sub>	A	7.27	7.19	7.12	6.99	7.01	6.92	6.81

NOCT: open-circuit module operation temperature at 800W/m<sup>2</sup> irradiance, 20°C ambient temperature, 1m/s wind speed.

## THERMAL CHARACTERISTICS

Nominal operating cell temperature	NOCT	°C	46 +/- 2
Temperature coefficient of P <sub>max</sub>	γ	%/°C	-0.45
Temperature coefficient of V <sub>oc</sub>	β <sub>Voc</sub>	%/°C	-0.33
Temperature coefficient of I <sub>sc</sub>	α <sub>Isc</sub>	%/°C	0.06
Temperature coefficient of V <sub>mpp</sub>	β <sub>Vmpp</sub>	%/°C	-0.45

## OPERATING CONDITIONS

Max. system voltage	1000V <sub>DC</sub>
Max. series fuse rating	15A
Limiting reverse current	15A
Operating temperature range	-40°C to 85°C
Max. static load, front (e.g., snow and wind)	5400Pa
Max. static load, back (e.g., wind)	2400Pa
Max. hailstone impact (diameter / velocity)	25mm / 23m/s

## CONSTRUCTION MATERIALS

Front cover (material / thickness)	low-iron tempered glass / 3.2mm
Cell (quantity / material / dimensions / number of busbars)	60 / multicrystalline silicon / 156mm x 156mm / 2 or 3
Encapsulant (material)	ethylene vinyl acetate (EVA)
Frame (material / color / anodization color / edge sealing)	anodized aluminum alloy / silver / clear / silicone or tape
Junction box (protection degree)	≥ IP65
Cable (length / cross-sectional area)	1100mm / 4mm <sup>2</sup>
Plug connector (type / protection degree)	MC4 / IP67 or YT08-1 / IP67 or Amphenol H4 / IP68

- Due to continuous innovation, research and product improvement, the specifications in this product information sheet are subject to change without prior notice. The specifications may deviate slightly and are not guaranteed.
- The data do not refer to a single module and they are not part of the offer, they only serve for comparison to different module types.

Yingli Green Energy Holding Co. Ltd.

service@yinglisolar.com

Tel: 0086-312-8929802

**YINGLISOLAR.COM**

© Yingli Green Energy Holding Co. Ltd. | DS\_YGE60Cell-29b\_40mm\_EU\_EN\_201211\_v02.20

## GENERAL CHARACTERISTICS

Dimensions (L / W / H)	1650mm / 990mm / 40mm
Weight	19.1kg

## PACKAGING SPECIFICATIONS

Number of modules per pallet	26
Number of pallets per 40' container	28
Packaging box dimensions (L / W / H)	1700mm / 1150mm / 1190mm
Box weight	534kg

Unit: mm

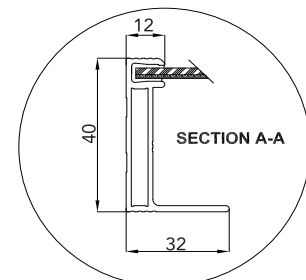
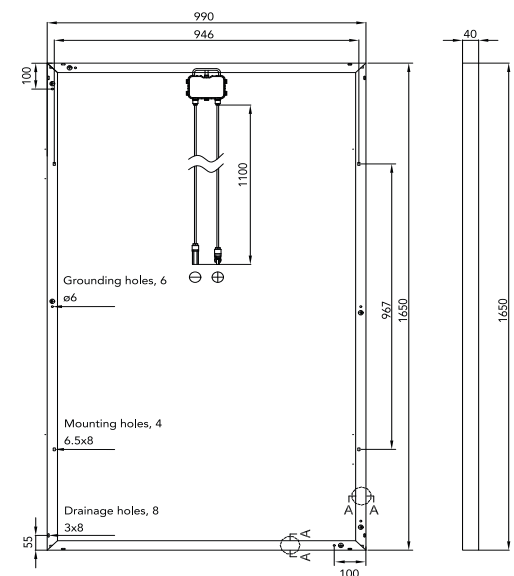

Warning: Read the Installation and User manual in its entirety before handling, installing, and operating Yingli Solar modules.

Our Partners:

